

BILL OF MATERIAL

NO.	PART NO.	QTY.	DESCRIPTION
1	P400* OR P410*L	1	SIMPLIPOINT GAGE
2	SEE TABLE	1	SIMPLIPOINT 180 ILLUMINATOR
3	SEE TABLE	1	SIMPLIPOINT 180 VIEWING HOOD
4	RPWA 34	4	THUMB SCREW - 5/16-18 x 1/2" LG
5	RPWA 22	1	POWER SUPPLY - 120VAC OR 240VAC
6	V21906 1.5	1	POWER CORD - NOT SHOWN

* = NUMBER OF PORTS IN THE GAGE GLASS

- POWER SUPPLY: 120 / 240 VAC @ 50 / 60 Hz
- MAXIMUM POWER CONSUMPTION: 500 mA
- AGENCY APPROVALS: FM/CFM ORDINARY LOCATIONS
- WIRE SIZE: MIN. 16 AWG

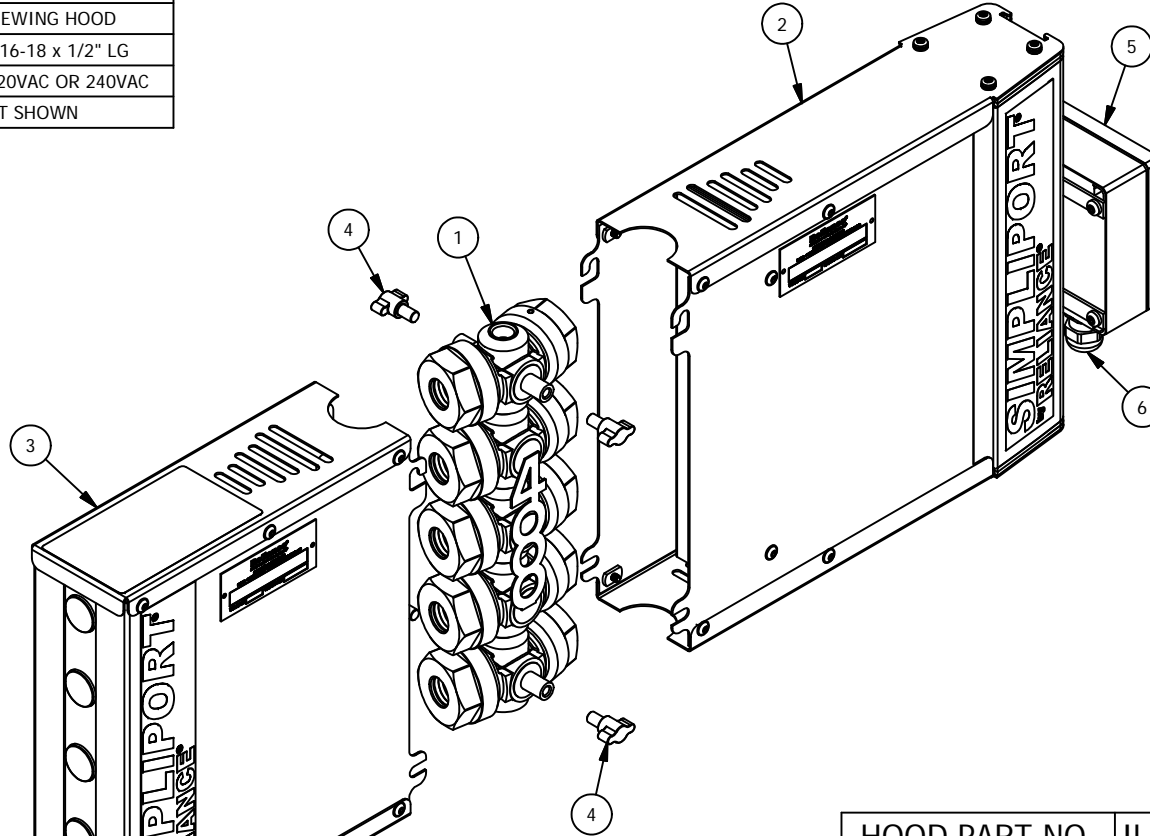

NOTES:

1. 5 PORT ILLUMINATION IS SHOWN. FOR THE ACTUAL ILLUMINATOR AND HOOD PART NUMBER, ADD THE NUMBER OF WINDOW UNITS ON THE SIMPLIPOINT GAGE FOR WHICH THE ILLUMINATION IS REQUIRED.
2. FOR ORDINARY (NON-HAZARDOUS) LOCATIONS.
3. POWER SUPPLY IS SUITABLE FOR 120 VAC OR 240 VAC APPLICATIONS.
4. REFER TO IOM #R500.E256A FOR ASSEMBLY AND WIRING DETAILS.
5. FOR GAGE MODELS GREATER THAN 10 PORTS, CONSULT FACTORY.

HOOD PART NO. (ITEM 3)	ILLUMINATOR PART NO. (ITEM 2)
RSWAH 5S	RSWAI 5S
RSWAH 6S	RSWAI 6S
RSWAH 7S	RSWAI 7S
RSWAH 8S	RSWAI 8S
RSWAH 9S	RSWAI 9S
RSWAH 10S	RSWAI 10S

REV	DATE	REVISION	BY
0	03/06/2019	INITIAL DRAWING	SDS

MANUFACTURED BY

 16633 FOLTZ PARKWAY
 STRONGSVILLE, OH 44149 USA
 (440) 572-1500 | www.clarkreliance.com
 © Clark-Reliance® Corporation. All Rights Reserved.

RELIANCE®

PAGE 1 OF 3

SIMPLIPOINT 180 WIDE ANGLE VIEWING HOOD AND LED
 ILLUMINATOR ASSEMBLY (STAINLESS STEEL)

PART NUMBER: SEE TABLE		REV.:	
TOLERANCE CLASS (PER PES-004): D		0	
MATERIAL:			
REVISION: 0			
DRAWN: SDS	DRAWING NO.:		PS1733
CHECKED: JWK	DATE: 2/25/2019		

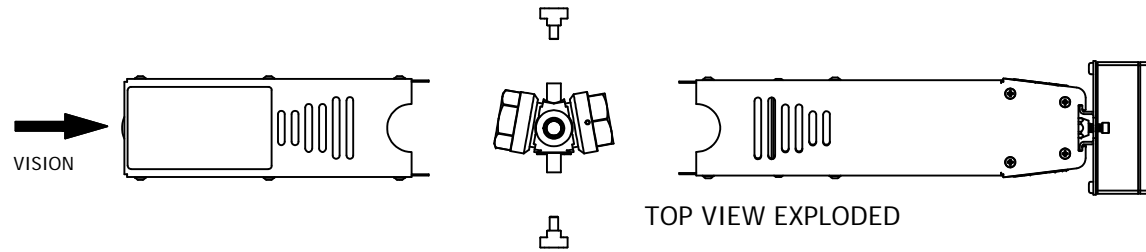

TOP VIEW EXPLODED

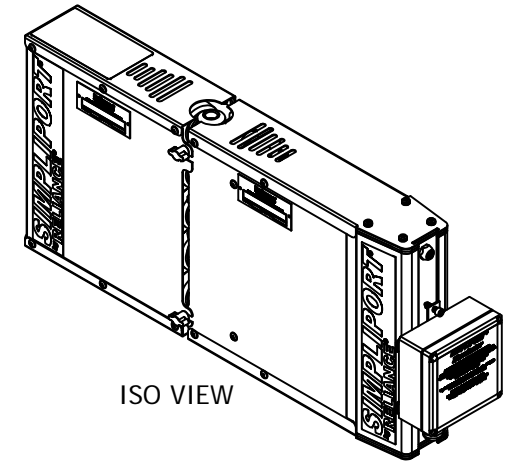
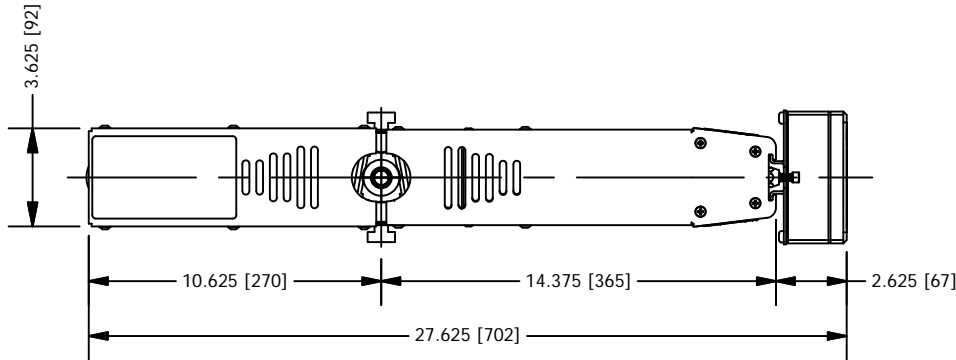

ISO VIEW

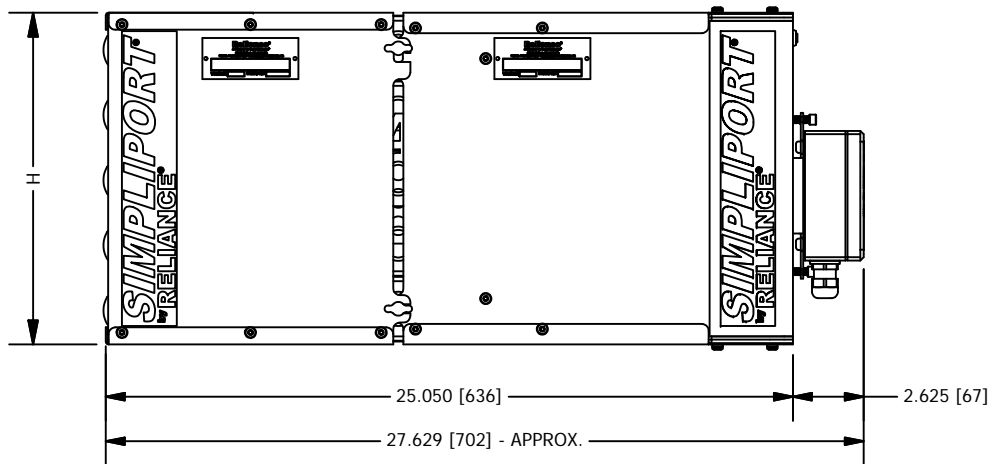

NOTES:

1. 5 PORT ILLUMINATION IS SHOWN. FOR THE ACTUAL ILLUMINATOR AND HOOD PART NUMBER, ADD THE NUMBER OF WINDOW UNITS ON THE SIMPLIPOINT GAGE FOR WHICH THE ILLUMINATION IS REQUIRED.

HOOD PART NO.	ILLUMINATOR PART NO.	H (IN)	H (MM)
RSWAH 5S	RSWAI 5S	12.125	307
RSWAH 6S	RSWAI 6S	14.500	368
RSWAH 7S	RSWAI 7S	16.875	428
RSWAH 8S	RSWAI 8S	19.250	488
RSWAH 9S	RSWAI 9S	21.625	549
RSWAH 10S	RSWAI 10S	24.000	609

MANUFACTURED BY
Clark-Reliance®
 16633 FOLTZ PARKWAY
 STRONGSVILLE, OH 44149 USA
 (440) 572-1500 | www.clarkreliance.com
 © Clark-Reliance® Corporation. All Rights Reserved.

RELIANCE®

PAGE 2 OF 3

SIMPLIPOINT 180 WIDE ANGLE VIEWING HOOD AND LED
 ILLUMINATOR ASSEMBLY (STAINLESS STEEL)

PART NUMBER: SEE TABLE		
TOLERANCE CLASS (PER PES-004): D		
MATERIAL:		
REVISION: 0		
DRAWN: SDS	DRAWING NO.:	REV.:
CHECKED: JWK	PS1733	0
DATE: 2/25/2019		

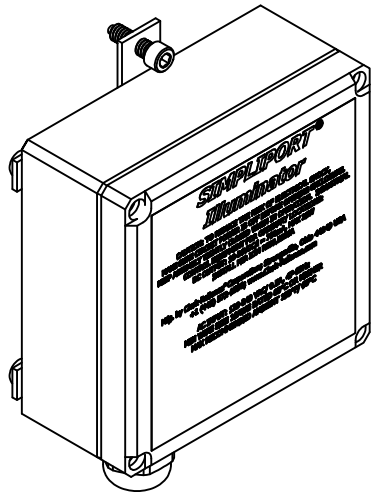

- POWER SUPPLY: 120/240 VAC @ 50-60 Hz
- MAXIMUM POWER CONSUMPTION: 500 mA
- AGENCY APPROVALS: FM/CFM ORDINARY LOCATIONS
- WIRE SIZE: MIN. 16 AWG

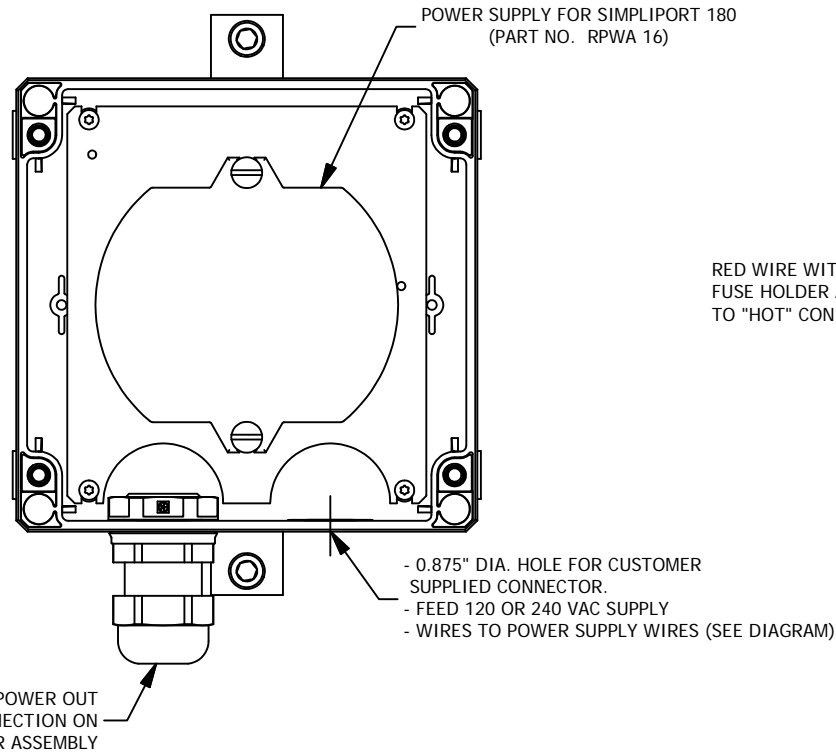

WIRING TO 120/240 VAC POWER
(PROVIDED BY INSTALLER)
FIELD WIRING CONNECTIONS

RED WIRE WITH INLINE FUSE HOLDER AND FUSE TO "HOT" CONNECTION

WHITE WIRE TO "NEUTRAL" CONNECTION

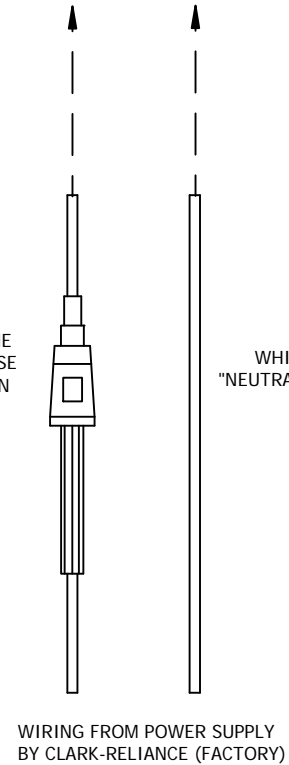

NOTE: ALL FIELD WIRING IS TO BE DONE BY A QUALIFIED ELECTRICIAN IN ACCORDANCE WITH ALL APPLICABLE ELECTRICAL CODES AND ORDINANCES.

MANUFACTURED BY
Clark-Reliance®
16633 FOLTZ PARKWAY
STRONGSVILLE, OH 44149 USA
(440) 572-1500 | www.clarkreliance.com
© Clark-Reliance® Corporation. All Rights Reserved.

RELIANCE®

PAGE 3 OF 3

SIMPLIPOINT 180 WIDE ANGLE VIEWING HOOD AND LED ILLUMINATOR ASSEMBLY (STAINLESS STEEL)

PART NUMBER: SEE TABLE		
TOLERANCE CLASS (PER PES-004): D		
MATERIAL:		
REVISION: 0		
DRAWN: SDS	DRAWING NO.:	REV.:
CHECKED: JWK	PS1733	0
DATE: 2/25/2019		